

Table of contents

Article numbers	page 3
Packing details	page 4
Assembly and use	page 5
Dimensions	page 6
Specifications	page 7
Safety & test	page 8

Article numbers

Article number	EAN code
DF0X1 7SXX1	5 708499 111638
DF0X1 7BXX1	5 708499 111720

Ordering example

DF 0X1 7 B XX1

Free numbers	
Colour	S = Alu-look (RAL 9006) B = Black (RAL 9004)
AC Plug and voltage	2 pin EU plug, 110-230VAC (if selecting Power Box A)
Series	0X1
Column type	DF = Desk Frame

Packing details

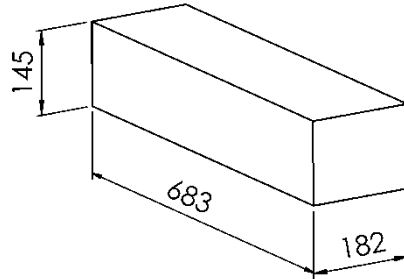

1 pcs.

14 kg

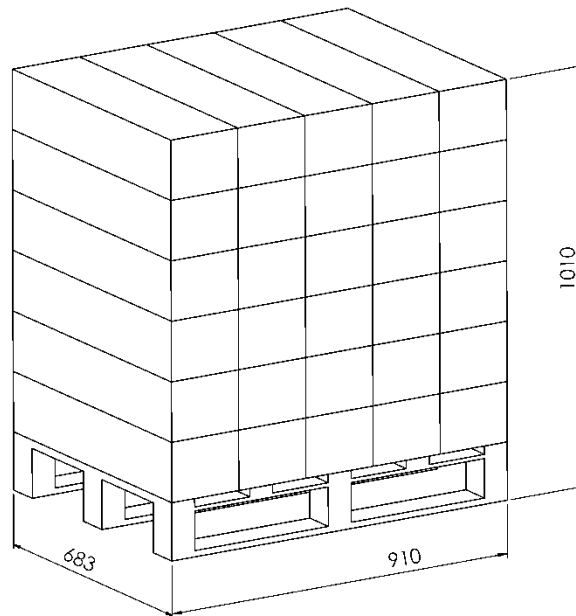

30 pcs.

440 kg

Assembly and use (if selecting Power Box A)

After installation of the column, the electrical components can be connected. All wires have DC jacks and since using different types (size- male/female) only the correct connection can be made.

All products come with an instruction manual.



This operation unit has two rocker switches integrated into a control panel.

The column can be raised and lowered by using the Up and Down buttons and can be stopped at all levels.

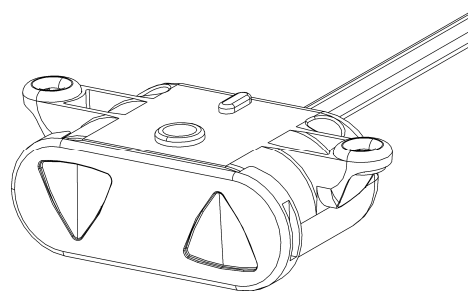

Dimensions

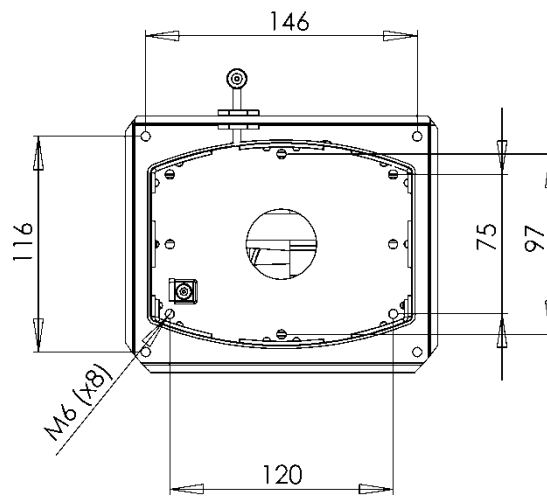
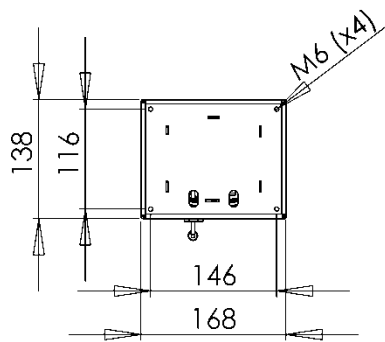
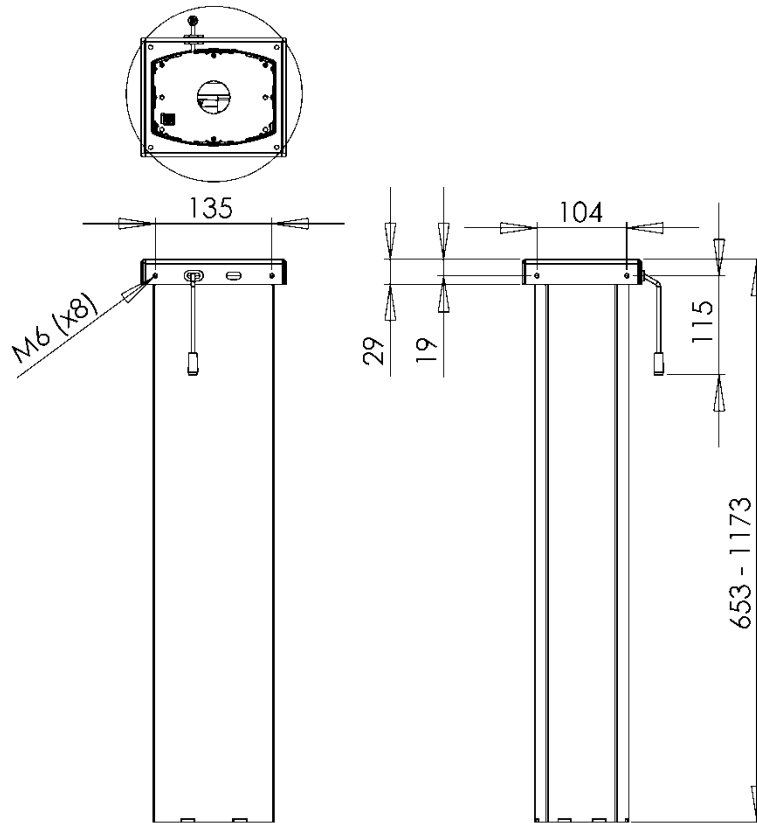

Specifications

Column

Height	65 – 117 cm
Max. working loads:	65 kg (by standard installation) 29 kg (when mounted upside down) 100 kg peak load
Duty cycle:	10% by 50% of working load or max 2 min. continuously
Speed	28 mm/sec (unloaded)

Components

Metal sheet parts:	St 37-2
Gear parts:	St 70-2
Gear motor:	CS no. #132010
Power supply:	30VDC AC/DC Power Transformer* Standby less than 0,15 Watts
Plastic components:	PEHD, PA6
Surface treatment	Visible metal parts powder coated in "alu" colour (RAL9006) or black colour (RAL 9004) Non visible metal parts are surface treated (e.g. zinc plated)

* if selecting Power Box A

Safety & Test

DECLARATION OF CONFORMITY

We hereby declare, under our sole responsibility that the following products:

- VENSET column type DF0X1XXX1

which are covered by this statement, are in conformity with the following standards and other normative documents::

- Counsel Directive 98/37/EF
- Counsel Directive 89/336/EØF with later changes
- Counsel Directive 73/23/EØF with later changes